

**Instructions for Use  
Wire Guides with Extension**

---

**1. Insert the wire passer around the bone (all shown below).**

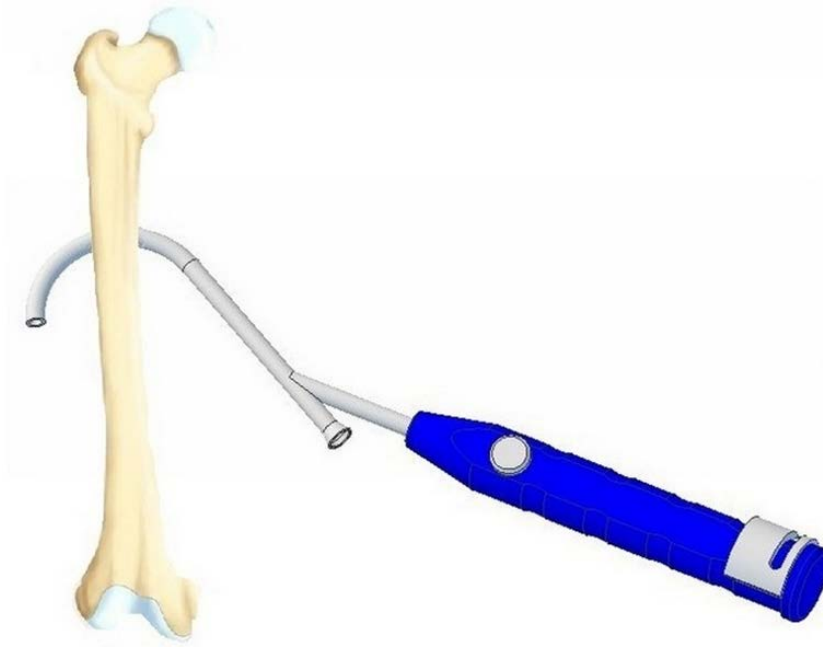

**2. Insert the auxiliary tool.**

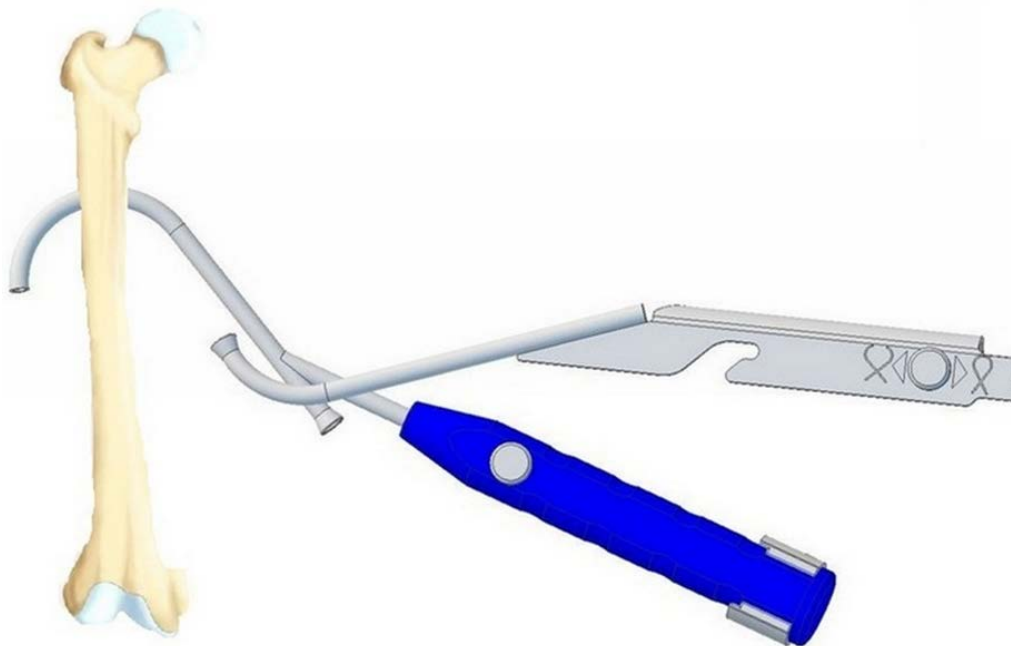

**Instructions for Use  
Wire Guides with Extension**

---

**3. Combine and close both components.**

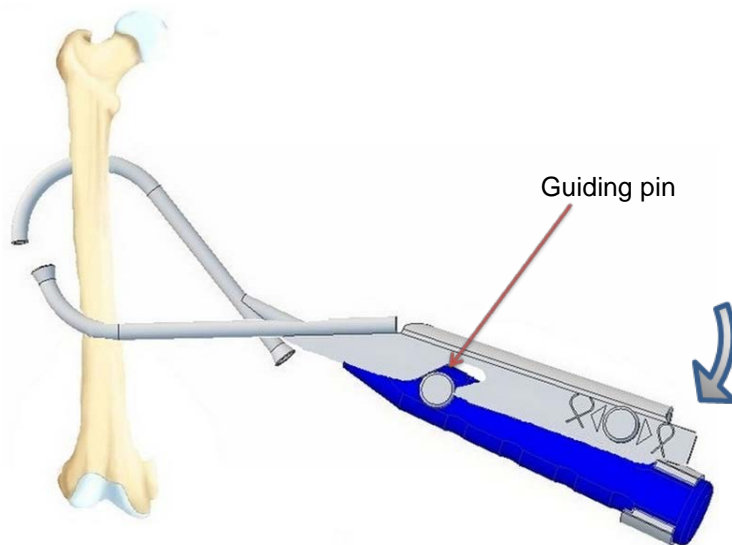

- Put the notch of the auxiliary tool over the guiding pin and gently slide the components together.
- Align the handle and the auxiliary tool. During the process, the auxiliary tool slides in the notch.

**4. Check the correct position once connected.**

- Align the auxiliary tool until it reaches the end of the notch.

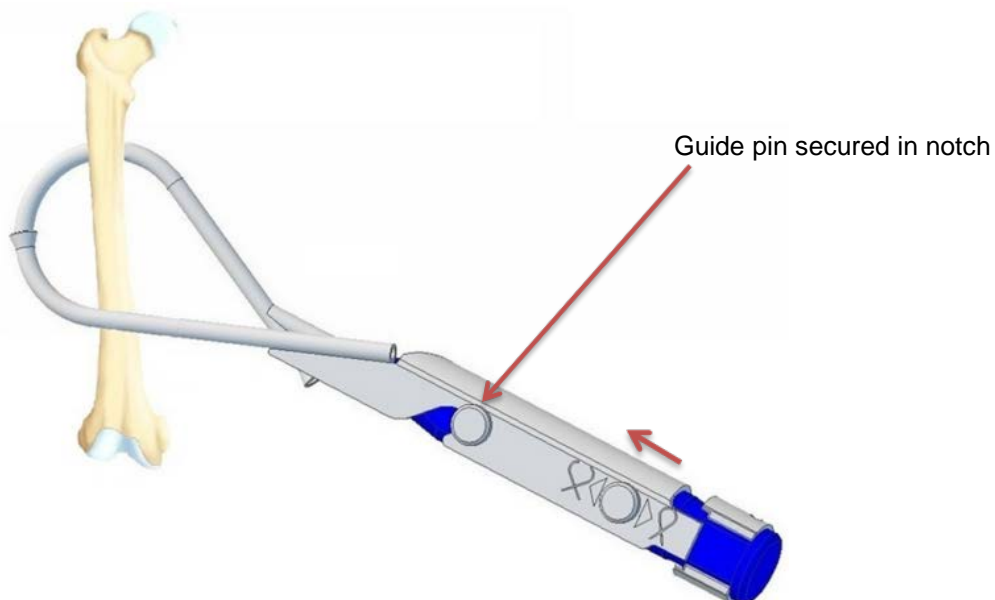

**Instructions for Use  
Wire Guides with Extension**

---

**5. Lock the components by turning the safety ring.**

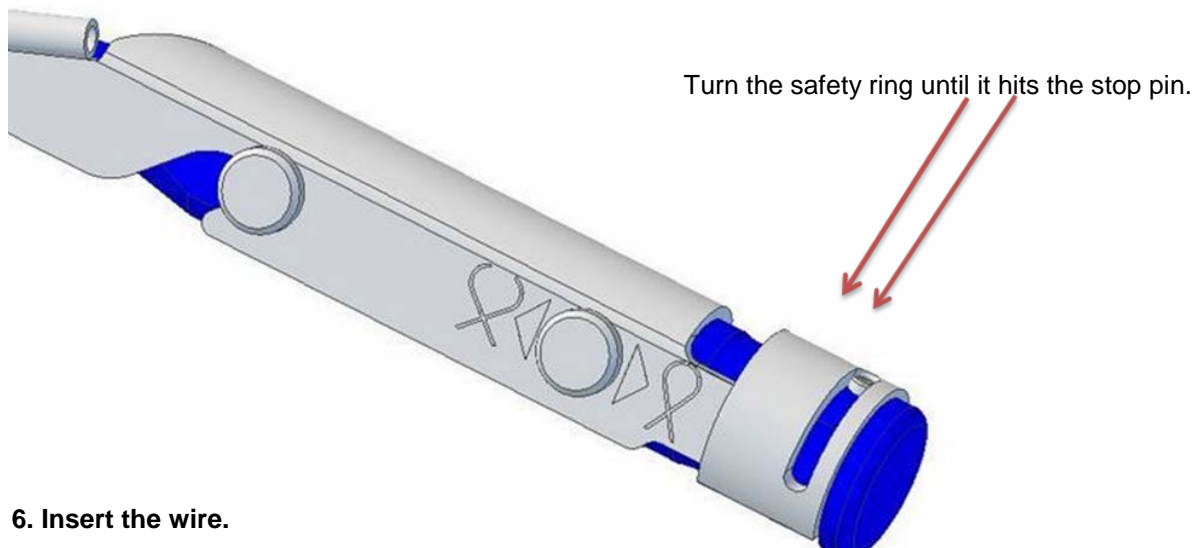

**6. Insert the wire.**

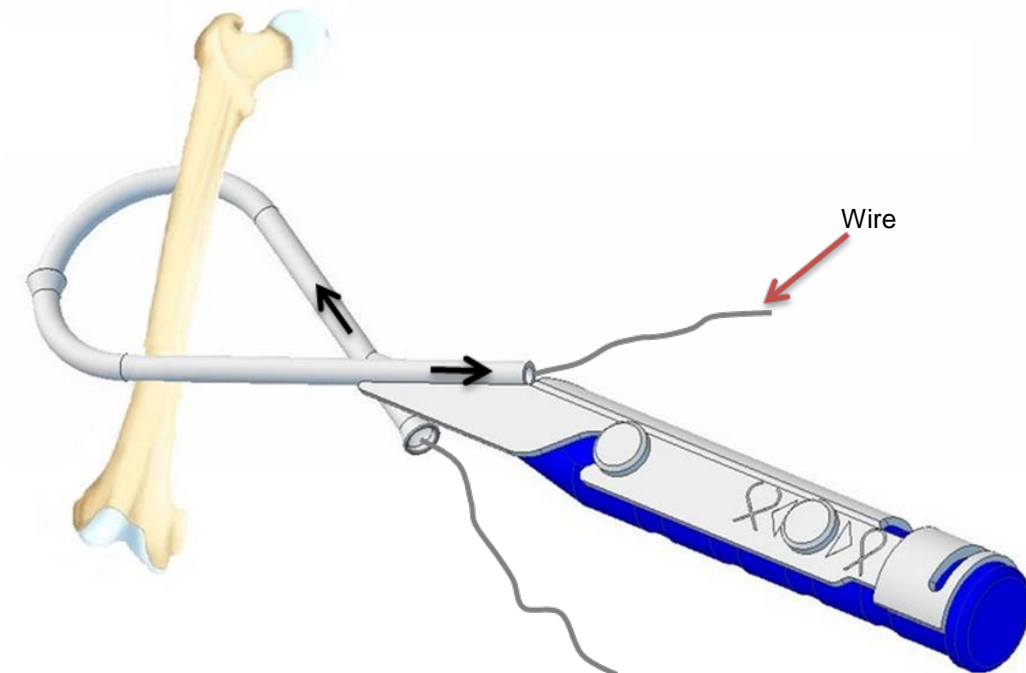

- Insert the wire in the direction indicated by above black arrows.
- Disassembly occurs in reverse order. Make sure that the wire does not retract during the process.

**Instructions for Use  
Wire Guides with Extension**

---

gSource, LLC does not accept any liability if these instructions for use have not been observed or followed.

Replacement parts can be obtained from gSource:

gS 82.5245 Wire Guide with Extension 11" Ø 45mm, plastic handle, blue

gS 82.5250 Wire Guide with Extension 11 ½" Ø 70mm, plastic handle, blue



 : gSource, LLC  
19 Bland Street  
Emerson, NJ 07630  
USA  
Phone: +1 (201) 599-2277  
email@gSource.com  
www.gSource.com



**gSource LLC**  
19 Bland Street, Emerson NJ 07630  
Phone: 001 (201) 599-2277  
email@gsource.com

